

# Solar Water Feature

## Outdoor use



In the interest of safe and proper use of this product, please read these instructions carefully and retain them for future reference.

### Contents:

Main unit and solar pump (When opening the packaging, please ensure all of the parts are complete.)

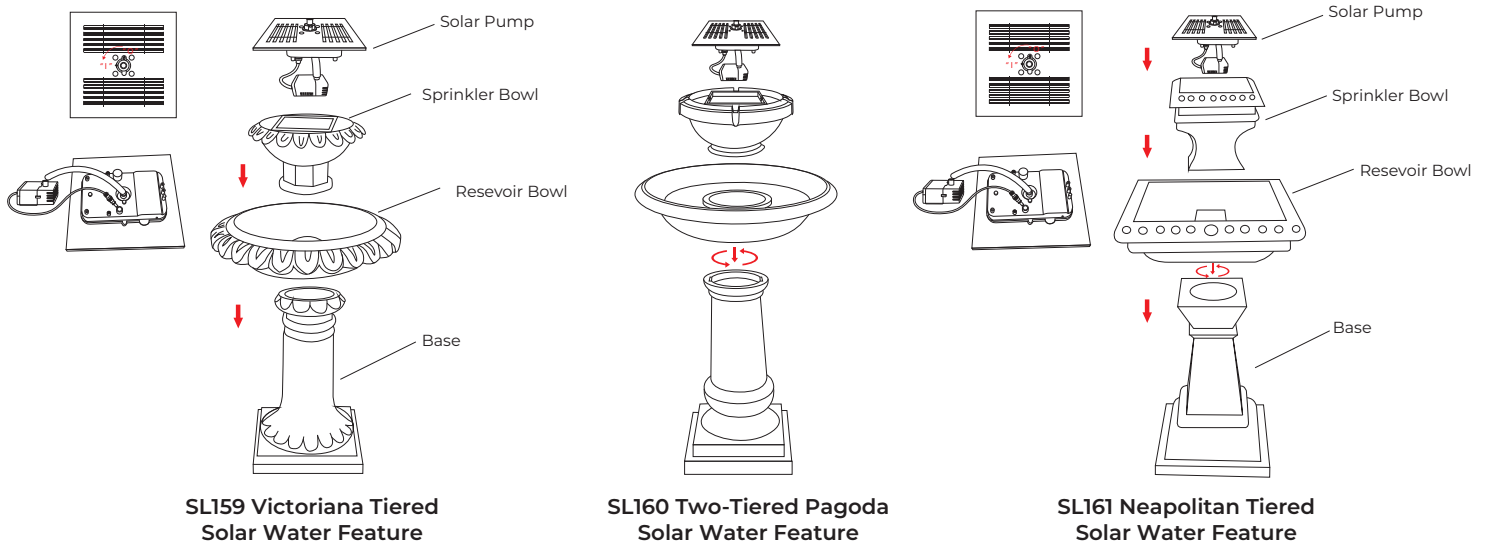

### Assembly:

1. Unpack all components carefully.
2. Place reservoir on top of the base and twist the reservoir clockwise to fit together as shown in diagram.
3. Connect the pump cable to the socket on the bottom of the solar panel, then connect the tube between the vent of the pump and the connection underneath the solar panel.
4. Pour enough water into the reservoir bowl and ensure the pump is fully submerged when placing the solar pump on top of the sprinkler bowl.
5. Connect the desired sprinkle head to the fountain head on the solar panel for different sprinkle functions.

### Operation:

1. The solar panel works by generating energy from sunlight, converting it into an electrical current which charges the rechargeable batteries. These batteries then power the pump. When switched on, an in-built sensor controls the lights. The level of battery charge and duration of light time depends on the amount of sunlight received, so the lights will remain illuminated for longer during the summer months. (Note: LED lights will only function at night).

A: Turn the switch to the "I" position, the pump will run every day by solar, the lights will illuminate at night.





B: Turn the switch to the "O" position, this will turn the pump off and charge the solar battery.

C: If the battery is fully charged, you can turn the switch to the "I" position at night and the pump will run for 6 hours.

### Caution:

- This product is suitable for outdoor use although it cannot be used, or submerged in water. If the product becomes damaged, the product must be disposed of accordingly.
- This product **MUST NOT BE MODIFIED**. If any modifications are made, this will invalidate the warranty and may render the product unsafe.
- This product is designed for decorative purpose only. Keep out of reach from children and animals.
- The LEDs in this light cannot be replaced.
- Do not position this product near any source of direct heat.

Note: the life span of this product is subject to the way in which it is handled, during use and storage.

Weather:	<b>Switch to "I" position:</b> 1. Pump is on 2. Charge extra solar energy to battery	<b>Switch to "O" position :</b> 1. Pump is off 2. Charge full solar energy to battery
	Solar runs the pump and charges the battery. Pump performance is maintained when the clouds pass. The pump will run on for 1 hour longer into the evening.	Battery should fully charge in 1 day.
	Solar runs the pump and supplies extra energy to the battery. Performance is maintained when the clouds pass. The pump will run for a shorter period of time into the evening.	Battery will take 2 to 3 days to fully charge.
	The pump will only run when there is sufficient power from the battery. If little or no battery charging occurs the pump performance is not maintained.	Battery will take several days to fully charge.
	No solar power is available, the pump will not run and the battery will not charge.	Battery will not charge.
If the pump stops running when the switch is on the "I" position (when cloudy or at night), you can run the pump for a couple of hours extra by turning the switch from (I) to (O) to (I), the pump will now run until battery flat. A fully charged battery will run for a maximum on 6 hours. <b>(Note: LED lights will only function at night).</b>		

## Cleaning and Maintenance:

**Solar panel:** The panel should be cleaned occasionally with a clean soft cloth. Regular cleaning of the panel is advised to maintain optimum conversion of the sun's energy into direct current.

**Pump:** If, after a period of time, the pump starts to lose power or stops working check for the build up of sediment, scale or dirt in the filter. Remove the pump cover and the impeller cover. Take out the impeller and remove any sediment, scale or dirt that has built up. Take out the two filter units from each end of the pump and wash them with running water.

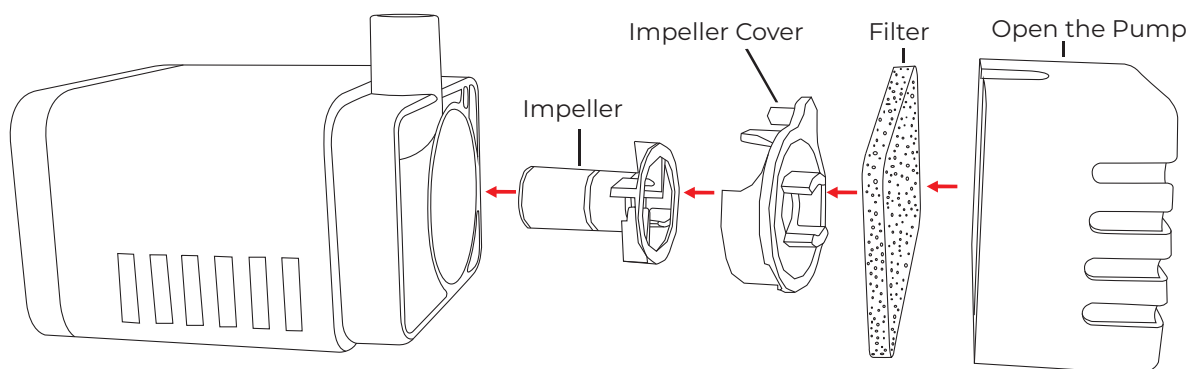

This product comes with a 12 month manufacturer's warranty against failure to all parts. If you have a warranty claim, please use the contact details below. For any technical information relating to this product, please email Festive Lights Ltd on [contact@festive-lights.com](mailto:contact@festive-lights.com). We aim to respond within 2 working days. Alternatively, please contact our help line on +44 (0)1257 792111. This service is available between 9.00am-5.00pm Monday to Friday.