



Nanoleaf Shapes

User Manual





Contents

4 Product Setup

5 Designing Your Layout

6 Mounting Your Shapes

8 Product Pairing

9 Pairing to the App for iOS

11 Pairing to the App for Android

13 Product Control

19 Problems & Solutions

20 Reset Options

21 Common Solutions

24 Placement Tips

25 Large Installation Tips

Additional Resources

[WARRANTY](#)

[ONLINE MANUAL](#)

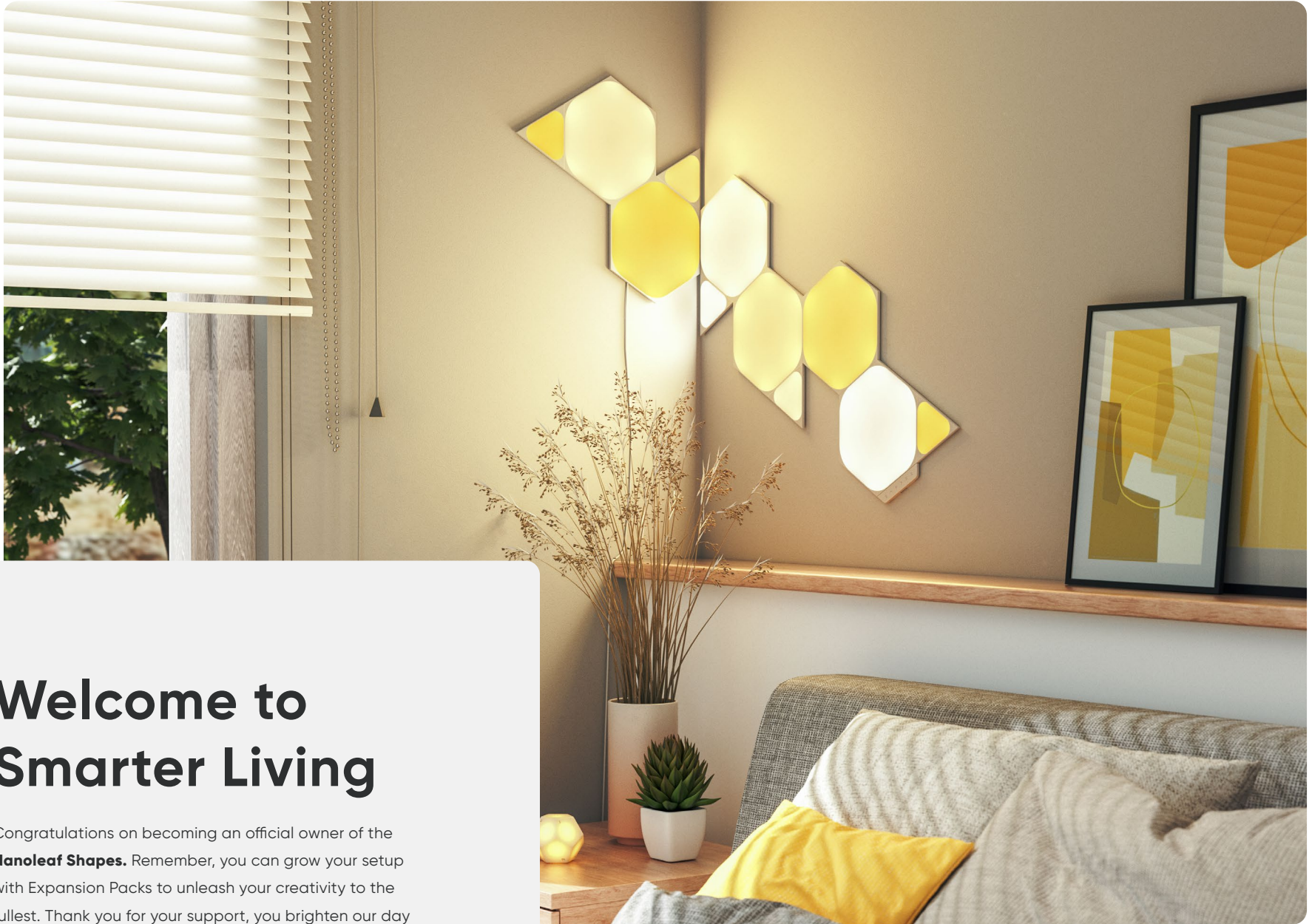

Welcome to Smarter Living

Congratulations on becoming an official owner of the **Nanoleaf Shapes**. Remember, you can grow your setup with Expansion Packs to unleash your creativity to the fullest. Thank you for your support, you brighten our day like Nanoleaf brightens the world!



Product Setup



Product Setup

Designing Your Layout

Slow down tiger! Before you mount your panels onto the wall, plug it in to a power source and try it out on a table or floor. Make sure your design fits into your space by measuring the width and height of your intended setup. For the best placement of your panels, please refer to [page.24](#). You can also use the tools below to help plan out your design!



Layout Assistant

Explore different panel layouts with the Layout Assistant and preview them in your room using the AR feature. Download the Nanoleaf App and open the Layout Assistant to get started.



Flex Linkers

Extend the possibilities of your Nanoleaf Shapes even further! Bend around corners, mount the panels to angled surfaces, maybe even create something a little radical. Each linker bends 360 degrees.



Design Inspiration

Get inspired by the Nanoleaf community! Check out our Social Media channels to see what other Nanoleaf owners are creating or explore the Nanoleaf Library of Shapes [here](#) ([go.nanoleaf.me/inspiration](https://nanoleaf.me/inspiration)).



PSU Calculator

Make sure you have enough PSUs for your layout. Find the PSU Calculator [here](#) (nanoleaf.me/en-US/products/nanoleaf-shapes/get-started/#psu-calculator).



Product Setup

Mounting Your Shapes

1 Prepare Your Surface

The Nanoleaf Shapes should only be installed indoors and on a flat surface that can support the weight of the panels. Clean your surface to be free of dust and moisture (1.1). The included Mounting Tape is **NOT** recommended for textured, porous, popcorn and ceiling surfaces – ie. wallpaper or brick walls (1.2).

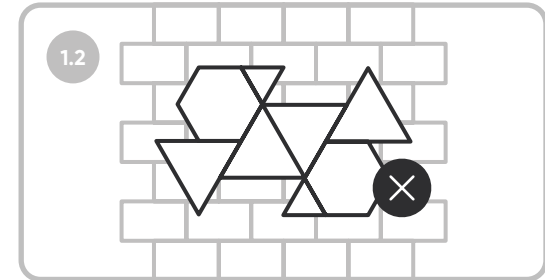
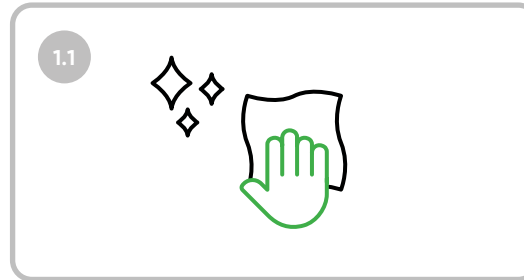

2 Set Up Your First Panel

Designate a panel from your layout as the starting panel. Attach all needed linkers before you attach any panel to the wall.

3 Connect the Controller & PSU

With your first panel, connect the Controller and PSU. This will ensure that your setup is properly working as you continue to connect your panels together. The position of these can be changed to your liking later on.

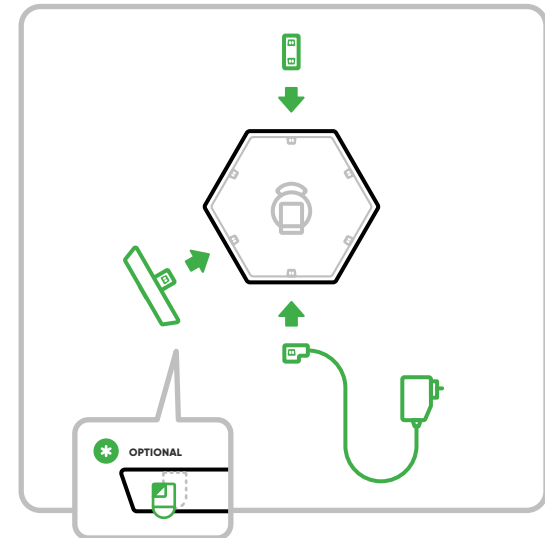

4 Mount Your Panel

Remove the protective liner from the tape and position your panel into place. Mount your panel by applying **strong pressure** to the center (this should be where the Mounting Plate is on the reverse side). Make sure to **rub your fist in a circular motion for 30 seconds** to avoid any falling panels.

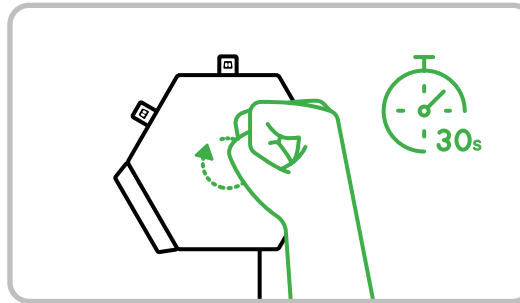

5 Complete Your Setup

Continue to add your panels ensuring that the linkers are fully snapped into the linker slot. The panels should be aligned edge to edge and should light up as each panel is added.

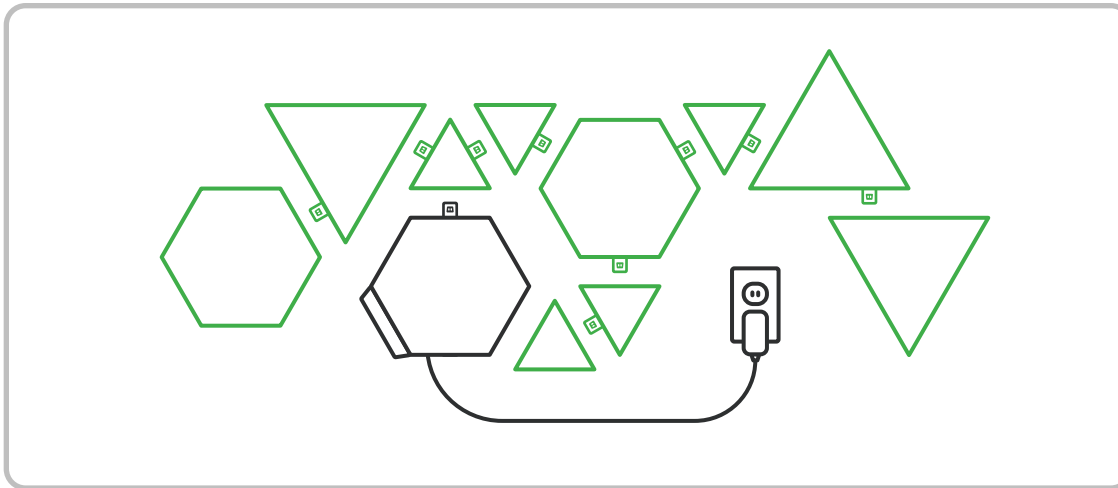

* Adding New Tape?

When you need to attach a replacement tape to your Mounting Plate, make sure the tape is placed **between the two holes**.

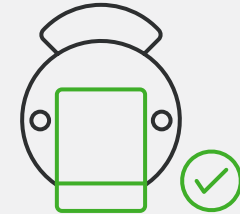

* Need to Dismount?

Gently snap the panel off from the Mounting Plate. With one hand on the plate, use the other to pull on the tail of the tape. **Pull directly down along** the wall. Do not pull the tape towards you or at any other angle, otherwise the tape may snap and damage your wall.

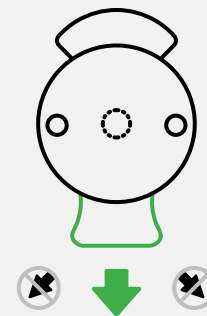



Product Pairing



Product Pairing

Pairing to the Nanoleaf App for iOS

iOS Standard Pairing Process

To ensure a smooth pairing process, please make sure you have the following things ready.



Your Device
Requires iOS 10+



Pairing Codes
Found on the Quick Start Guide, PSU or Controller



2.4 GHz Wi-Fi Network
5G networks are not compatible with Nanoleaf products



Connected Controller
A white light indicates that your Shapes are ready for pairing

1 Download & Open the Nanoleaf App

The **Nanoleaf Smarter Series App** can be found in the Apple Store.

2 Pair Your Shapes

- 2.1. Select the **MORE** tab **...**
- 2.2. Select **MY DEVICES** and **+** to add a device.
- 2.3. Select **SHAPES** as your product and **START PAIRING**.
- 2.4. The camera will open automatically.
- 2.5. Scan the HomeKit pairing code to pair.
- 2.6. Your Nanoleaf Shapes should now be connected and ready to go.

* iOS Additional Pairing Methods

OPTION A: Pair with NFC Tap

1. After Step 2.4 in the Standard Pairing Process, hold the top of your device over the buttons of your Controller.
2. A connection should be automatically established and your Shapes will be paired.

OPTION B: Pair with Manual Input

1. Select **I Don't Have a Code or Can't Scan**
2. Enter the 8-digit pairing code (can be found on the Quick Start Guide, PSU or Controller).

"How can one setup be controlled by multiple iOS users?"

This will require the **Apple Home App** and the **Nanoleaf App**.

1 Primary User

- 2.1 Open the Nanoleaf App
- 2.2 Select the **MORE** tab **...**
- 2.3 Select **USERS**
- 2.4 Invite the secondary user with their Apple ID email.

2 Secondary User

- 2.1 An invitation from the primary user should appear for you to accept.
- 2.2 Open the Home App and select the home icon in the top left.
- 2.3 Under **HOME SETTINGS**, a list of homes will appear.
- 2.4 Accept the home that has been shared with you. This will give you control of the Shapes as well as any other HomeKit devices in the same home.

Product Pairing

Pairing to the Nanoleaf App for Android

Android Standard Pairing Process

To ensure a smooth pairing process, please make sure you have the following things ready.



Your Device
Requires Android 5.0+



Pairing Codes
Found on the Quick Start Guide, PSU or Controller



2.4 GHz Wi-Fi Network
5G networks are not compatible with Nanoleaf products



Connected Controller
A white light indicates that your Shapes are ready for pairing

1 Download & Open the Nanoleaf App

The **Nanoleaf Smarter Series App** can be found in the Google Play Store.

2 Pair Your Shapes

- 2.1. Ensure your location settings are enabled on your device.
- 2.2. Select **DEVICES**, located in the side menu on the left.
- 2.3. Select **+** to add a device.
- 2.4. Select **SHAPES** as your product and **START PAIRING** (see next page for pairing options).



* Pairing Options

OPTION A: Pair with a QR Code

1. Scan the QR Code found on the Quick Start Guide, PSU or Controller.

OPTION B: Pair with NFC Tap

1. Ensure that NFC is enabled on your device.
2. Hold the top of your device over the buttons of your Controller.
3. A connection should be automatically established and your Shapes will be paired.

OPTION C: Pair with Manual Input

1. If you have more than one set of panels connected to your network, select the magnifying glass to identify the correct setup (it will flash green).
2. Once identified select **TAP TO PAIR**
3. Enter the 8-digit pairing code (found on the Quick Start Guide, PSU or Controller).





Product Control



Product Control

Controlling your Shapes (1/5)



Controller

The Controller is the brain of the Nanoleaf Shapes. The touch control buttons on the Controller provide convenient shortcuts to common commands. The Controller can also be attached to any available linker slot in your layout.



Power ON/OFF



Next Rhythm Scene

Cycle through Default or Saved Rhythm Scenes.



Next Color Scene

Cycle through Default or Saved Color Scenes.



Dim/Brighten



Shuffle

The Controller comes with dozens of preloaded Scenes. Hold the Shuffle button to return to a previous random Scene.



Controlling your Shapes (2/5)



Advanced Button Controls (1/2)

The Controller is the brain of the Nanoleaf Shapes. The touch control buttons on the Controller provide convenient shortcuts to common commands. The Controller can also be attached to any available linker slot in your layout.



Return to previous random Scene

Hold button down for 3 seconds

The last 5 randomly Scenes will be loaded. A flash of yellow on the panels will indicate that you are at the end of your browsing history.



Activate White Lighting Mode

Tap buttons together

Cycle through the following preset white light modes: Warm White (2700K), Reading Light (4000K), Daylight White (5000K).



Pair a Remote or Third-Party App

Hold button down for 3 seconds

This opens a 30s window to pair your devices.



Save a Current Scene

Hold button down for 3 seconds

This saves the current Scene if it's not already saved. This is most useful for saving Scenes you like when using Shuffle.



Activate Power Diagnostic Mode

Hold buttons down for 5 seconds

If you have more than 21 panels connected to your Controller, this enables or disables Power Diagnostic Mode. This mode helps you place additional power supplies to optimize your Nanoleaf Shapes system.



Controlling your Shapes (3/5)



Advanced Button Controls (2/2)



Activate Wi-Fi Hotspot Mode

Hold buttons down for 30s

This mode allows your Controller to act as a local network hotspot without an Internet connection. With this mode active, you can use the Nanoleaf App to operate your Nanoleaf Shapes without needing a router or access point.

NOTE: During Wi-Fi Hotspot Mode, your Controller will not be able to download firmware updates. Discover content from the community will also be unavailable.



Touch Actions

Touch Actions transform each light panel into a smart button, allowing for the most seamless control of your entire smart home. With as little as a single press on a panel, activate HomeKit Scenes to control any or all of your HomeKit products at once. See it in action [here](https://youtu.be/KWCBxYDoHwA) (youtu.be/KWCBxYDoHwA).



Touch Gestures

Touch Gestures can be used to change brightness, Scenes or turning your Shapes on and off. Find more about this function [here](https://helpdesk.nanoleaf.me/hc/en-us/articles/360012732294-How-Do-I-use-Touch-Gestures) (helpdesk.nanoleaf.me/hc/en-us/articles/360012732294-How-Do-I-use-Touch-Gestures).



Product Control

Controlling your Shapes (4/5)



Nanoleaf App

Turn your lighting on and off, control brightness, group lights by home and by room, create and use Scenes, and much more.



Dashboard

Choose an existing Scene or create your own (Static, Dynamic, Rhythm, Group, or Layered). You can also use the Paint Tool to color panels individually.



Explore

Find helpful information including tutorials, new device features, etc.



Discover

Find and download new Scenes created by the Nanoleaf community.



Schedules

Automate your Scenes to turn on or off.



Nanoleaf Desktop App

With the Nanoleaf Desktop App, you can control your Shapes from a web browser on your computer. Create and download new Scenes right from your computer, and try Screen Mirror feature. The Desktop App was designed to simplify the management of larger installations and offer control of many different layouts at once. Download it online [here \(nanoleaf.me/en-CA/integration-hub/desktop-app\)](https://nanoleaf.me/en-CA/integration-hub/desktop-app).



Controlling your Shapes (5/5)



Voice Control

You can easily control your Shapes by voice in a few different ways. In the Nanoleaf App, make sure to name your panels with something easy.

Hey Siri

"Turn [Device Name] on/off."
"Set [Device Name] to 10% brightness."
"Brighten/dim the lights."
"Brighten/dim the lights to [%]."
"Set [Scene Name]."
"Set [Device Name] to [Scene Name]"
"Set [Device Name] to [Color]."

Hey Google

"Turn on [Device Name or Scene Name]."
"Turn on/off the lights in [Room Name]."
"Turn on/off all my lights."
"Turn off [Device Name]."
"Brighten/dim [Device Name]."
"Brighten/dim the lights in [Room Name]."
"Brighten/dim all my lights."
"Set [Device Name] to [%]."
"Set [Device Name] to [Color]."

Alexa

"Turn on [Device Name or Scene Name]."
"Turn off [Device Name]."
"Brighten/dim [Device Name]."
"Set [Device Name] to [%] brightness."
"Set [Device Name] to [Color]."



Nanoleaf Remote

The Nanoleaf Remote is a sleek, dodecahedron-inspired Bluetooth HomeKit remote designed to enhance the smarter home experience and make controlling the Nanoleaf Shapes and other HomeKit products even more convenient.



Brightness Control

Control the brightness of your Shapes by rotating the Remote clockwise or counterclockwise.



Save Scenes

Save your favorite Scenes to any of the twelve sides. Face up to activate.



Nanoleaf Open API

A local network API designed to extend your product experience. Integrate your setup with third party devices and services and enable more granular control of the hardware. Find out more about these controls [here](https://forum.nanoleaf.me/users/sign_in) (forum.nanoleaf.me/users/sign_in).





Problems & Solutions



Reset Options

A Soft Reset

Power cycle your lights by unplugging them from power and then plugging them back in.

1. On the Controller, hold the Power and Brighten buttons together for 15 seconds.
2. Let go once buttons start flashing.
3. Wait for the Power button LED to remain on and steady.
4. On the Nanoleaf App, delete the previous device and re-pair it again.

B Hard Reset

This will reset your Shapes to factory settings, deleting Wi-Fi settings, pairing information, and saved Scenes. Default Scenes and settings will be restored.

1. Unplug your Shapes from the power source.
2. While holding the Power and Brighten buttons, plug the Power Supply back into power.
3. Continue holding the buttons down until the button LEDs on the Controller come on.
4. Once the LEDs come on, quickly release the buttons. The LEDs will flash to indicate that the hard reset will now take place.
5. Wait about 2 minutes for a reboot. The Shapes are ready to be setup once the Power Button LED turns on and the panels begin cycling through different colors.

* Need to Restore Your Scenes?

If you are logged in to your Nanoleaf Account, scenes can be restored after a Hard Reset.

1. Open the Nanoleaf App and login to your Nanoleaf Account.
2. In the Dashboard tab, select the settings icon.
3. Under **SYSTEM > BACKUP AND RESTORE**, ensure that **DEVICE SYNC** is enabled.
4. Select **RESTORE FROM BACKUP** and **RESTORE**.



Common Solutions

(1/3)

"I moved or changed my Wi-Fi network."

A Wi-Fi Reset

This will allow you to connect your Shapes to a new Wi-Fi network.

1. Plug your Shapes in to a power source.
2. With the Power and the Brighten buttons on the Controller, press and alternate between them 5 times (10 presses total).
3. The Power button LED will become solid white.

"My Shapes are paired but unreachable."

A Toggle Your Wi-Fi

On your phone, toggle the Wi-Fi off, then on again.

B Power Cycle Your Controller

Unplug the Controller, then plug it back in.

C Power Cycle Your Router

Unplug your Router, then plug it back in.

D Soft Reset

See how to Soft Reset on [page.20](#).



Common Solutions

(2/3)

"I am not able to pair my Shapes."

A Check your Router Settings

1. Are you connected to a 2.4 GHz network? 5 GHz networks are not supported.
2. Ensure multicast, IGMP, UPnP (if available) are enabled on your router settings.

B Soft Reset

See how to Soft Reset on [page.20](#).

C Hard Reset

See how to Hard Reset on [page.20](#).

"I don't see my Shapes in the App for setup."

A Wi-Fi Troubleshooting (1/2)

Plug your PSU into power. The Power button on the Controller will light up after 1 minute.

If your Power button LED is **Solid White**

Your Shapes are ready to connect to your network. Check for and try the following:

1. Make sure your mobile device Wi-Fi is on.
2. Move your mobile device closer to your panels.
3. Toggle the Wi-Fi on your mobile device
4. Try a Hard Reset.



Common Solutions (3/3)

A Wi-Fi Troubleshooting (2/2)

If your Status LED is **Flashing**

Your Wi-Fi is configured, but the panels cannot connect to the target network. Try the following:

1. Power Cycle your Shapes (unplug your PSU from power, then plug it back in).
2. If your panels are paired on the Nanoleaf App, delete the device and re-pair them with the Standard Pairing Process.

If your Power button LED is **Unlit**

Your Wi-Fi is configured and connected to your router. Check for and try the following:

1. Make sure your mobile device is on the same network.
2. Toggle the Wi-Fi on your mobile device off, then on.



Problems & Solutions

Placement Tips

The following tips can help your Nanoleaf Shapes achieve the best wireless range & network reception.

- A.** Place your Shapes in an open area where there are less obstructions, such as large pieces of furniture or walls.
- B.** Avoid placing your Shapes behind furniture or inside cabinets.
- C.** Don't place your Shapes in areas surrounded by metal surfaces on three or more sides. This can cause signal issues.
- D.** Try to place your Shapes at least 25 feet (8 meters) away from any microwave oven, 2.4 GHz cordless phone, Wi-Fi devices, or other source of interference.
- E.** Place your Shapes as close to your Wi-Fi home router as possible. For best performance, keep the distance below 65 feet (20 meters) and have no more than one wall in between.



Problems & Solutions

Large Installation Tips (1/2)



How many PSUs do I need?

Make sure you have enough PSUs for your layout. Find the PSU Calculator [here](https://nanoleaf.me/en-US/products/nanoleaf-shapes/get-started/#psu-calculator) (nanoleaf.me/en-US/products/nanoleaf-shapes/get-started/#psu-calculator).

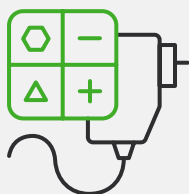

Problems & Solutions
Nanoleaf Shapes

A

Adjust Your Power Supplies for Optimal Performance

1

Activate Power Diagnostic Mode

If you have more than 21 Hexagons, more than 28 Triangles, or more than 77 Mini Triangles and/or multiple Controllers in your Shapes setup, you should try to distribute power supplies across your layout evenly. Activating Power Diagnostic Mode will give you tips on where you can place your power supplies for optimal performance. The options below will outline how this mode can be activated:

OPTION A: Activate with the Controller

1. On your Controller, hold the Dim (–) and Brighten (+) buttons down together for 5s.
2. A color-coded map of your panels will appear. The map will automatically update as you connect or move, power supply units within your setup.

OPTION B: Activate with the Nanoleaf App

If your setup is already optimized, these warnings will not appear and Power Diagnostic Mode will be inaccessible. If you wish to enable Power Diagnostic Mode anyway, the button sequence on the Controller can be used (see Option A).

For iOS Devices

1. Open the **MORE** menu.
2. Select **SETTINGS > WARNINGS > Power Limited**

For Android Devices

1. Open the side menu.
2. Select **SETTINGS > WARNINGS > Power Limited**

2

Distribute Power Supplies

Red: Power supply needs to be moved.

Blue: Number of power supplies needed and the best places to place them.

Green: Power supply is in an optimal place.

White: Alternative places to add a power supply. The brighter the panel, the better the placement.

Large Installation Tips (2/2)



Make Use of Nanoleaf Tools



Nanoleaf Desktop App

With the Nanoleaf Desktop App, you can control your Shapes from a web browser on your computer. Create and download new Scenes right from your computer, and try Screen Mirror feature. The Desktop App was designed to simplify the management of larger installations and offer control of many different layouts at once. Download it online [here \(nanoleaf.me/en-CA/integration-hub/desktop-app\)](https://nanoleaf.me/en-CA/integration-hub/desktop-app).



Nanoleaf Open API

A local network API designed to extend your product experience. Integrate your setup with third party devices and services and enable more granular control of the hardware. Find out more about these controls [here \(forum.nanoleaf.me/users/sign_in\)](https://forum.nanoleaf.me/users/sign_in).



Let's Get Social



@nanoleaf



@thenanoleaf

nanoleaf.me